

SAFETY® CALF HEADLOCK (ref. VE)



JOURDAIN

N°1 MONDIAL DU TUBULAIRE BOVIN

For calves up to 6 months.

General conditions of use

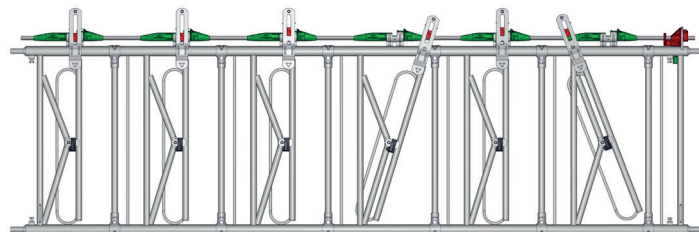
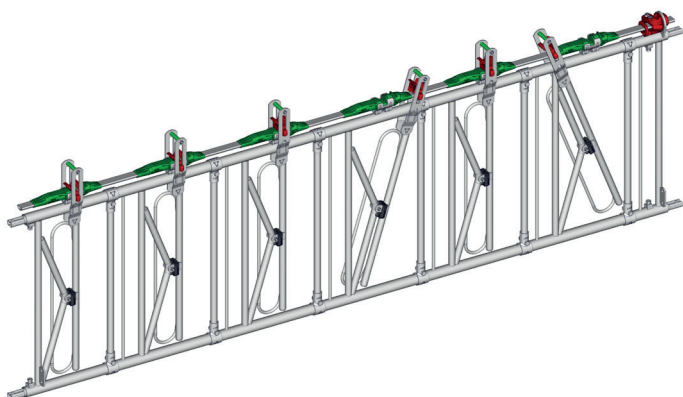

VE0403

Calf SAFETY® Headlock
6 places / 3.02 m

DESCRIPTION

The Calf SAFETY® Headlock is symmetrical, with a centre moving arm providing as much room at the entrance **1** as low safety clearance **3**.

The animals enter and exit in the upper section. The lower section **3** facilitates animal exit with help from the farmer.

Locking is in position **2**.

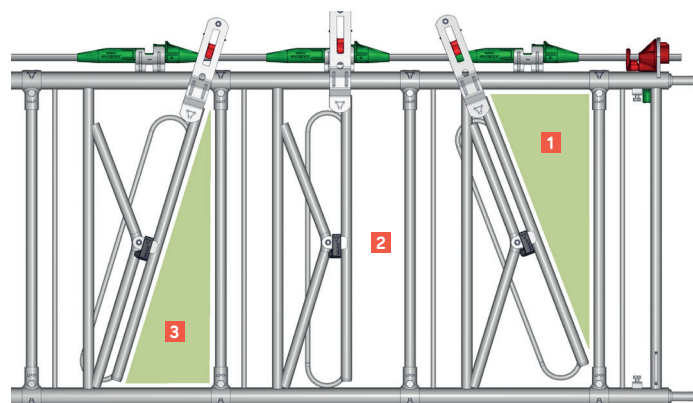

Suited for calves up to 6 months.

Locks the animals at the trough to limit food competition.

Facilitates animal sorting.

Allows intervention by the farmer for everyday care.

Often installed with a trough.

The moving arm joint is reversed compared with the adult headlock for comfort and to prevent hurting the neck of young animals.

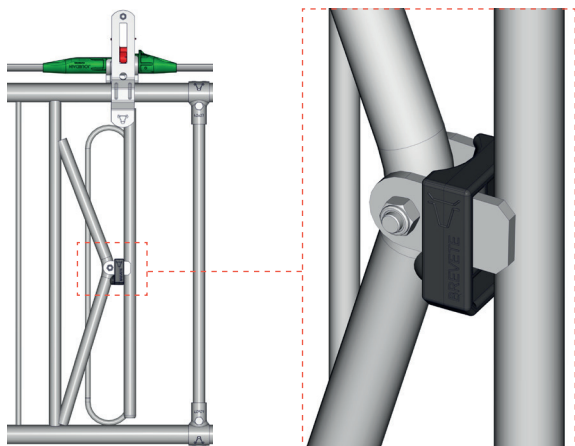

always
INNOVATING

INSTALLATION

The Calf SAFETY® Headlock must be fitted straight.

Nominal lengths correspond to specific JOURDAIN Ø 76 mm axis/post axis dimensions.

The Headlock features 4 stamped adjustment stands.

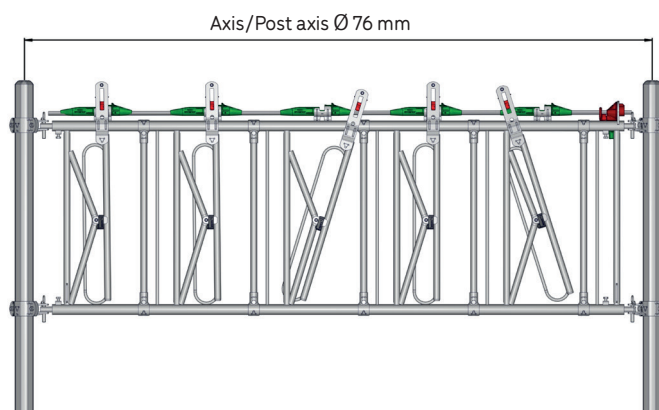
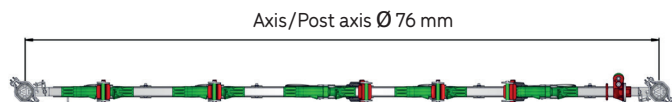

1 Central reinforcement and fitting height

The Headlock is fitted on a Ø 76 mm octagonal bracket, with easily adjusted height to match animal size.

For calves up to 6 months.

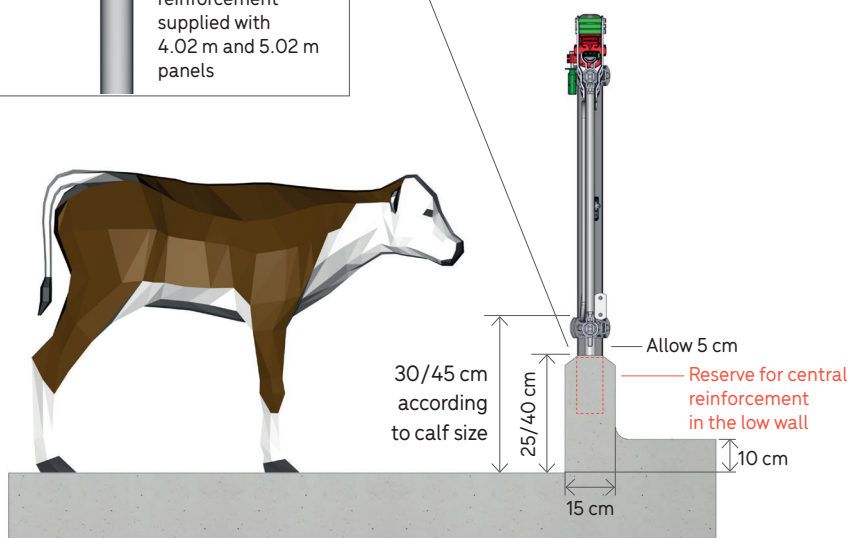
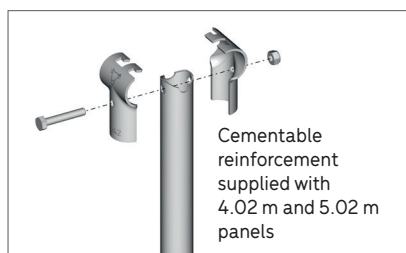

Without trough

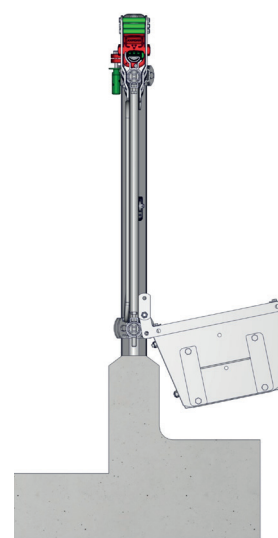

With trough

CAUTION

For a Headlock panel from 4.02 m and 5.02 m long, cementable reinforcement is supplied. It must be cemented to the low wall axis.

To limit corrosion, the Headlock should not be in contact with the low wall.

2 76 mm post assembly

With brackets. Assembly with brackets allows height adjustment.

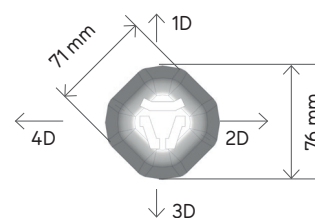
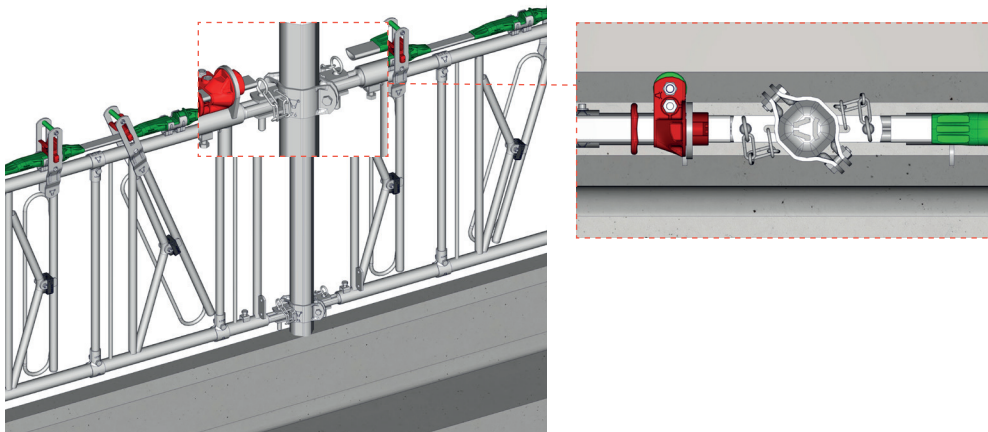

Post implantation
with 'barrier'
orientation

3 Mounting at wall end or framework post

When starting the installation, fasten the headlock on 2 simple yokes **ref. FE2102**.

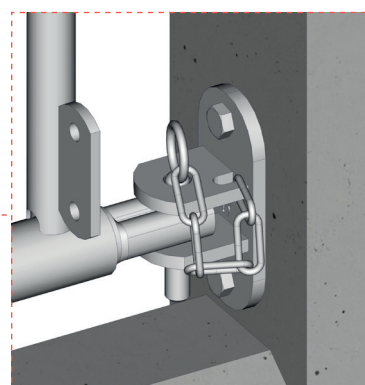
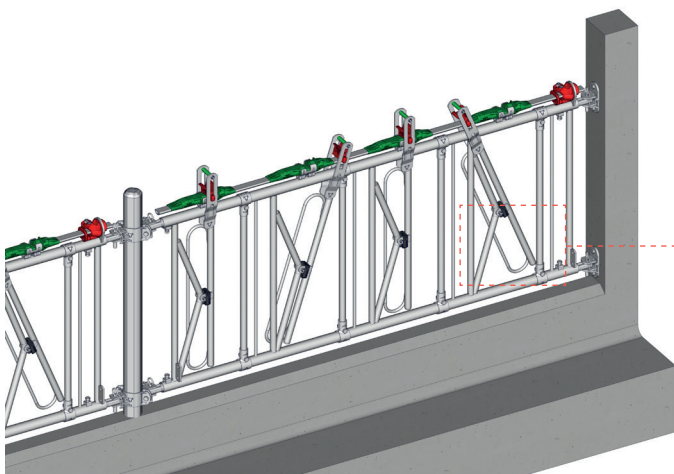

FE2102

4 Assembly on sleeve

Assembly on cementing sleeve **ref. TR4176** allows the post to be disassembled or a dual sleeve to be fitted to limit corrosion.

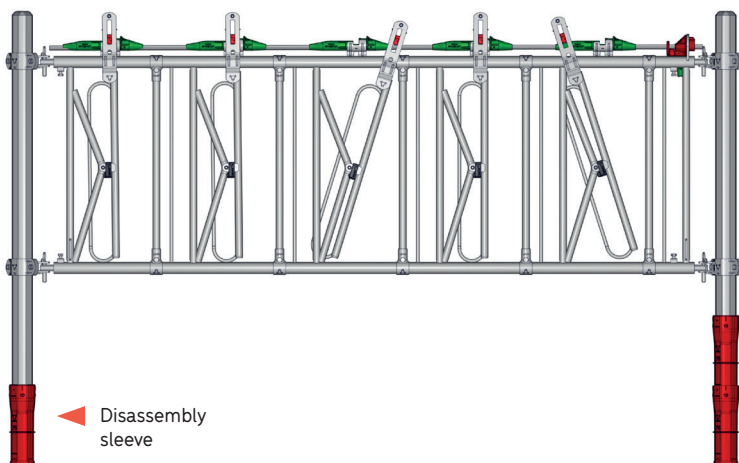

TR4176

Disassembly
sleeve

Corrosion restrictor
dual sleeve

5 Orientation

Place the calf head locking lug and the bucket holder supports on the feeding corridor side.

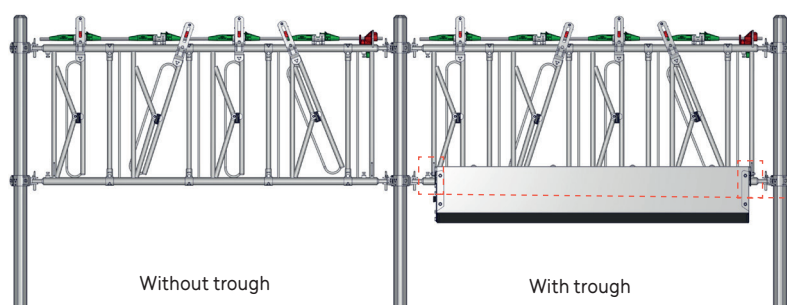

The metallic trough with cleaning hatch is fitted on the flats with the brackets on the feeding corridor side.

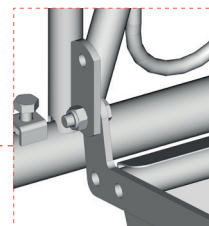

The metallic trough with its optional bucket holders **ref. VE2431** can hold buckets Ø 28,5 cm.

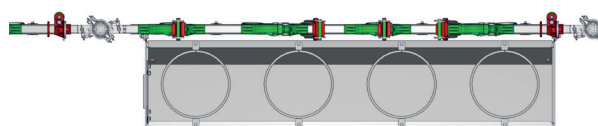

VE2431



6 Control lever and linkage connection for Calf Headlock

The control lever **ref. VE2515** is specific to the Calf Headlock range.

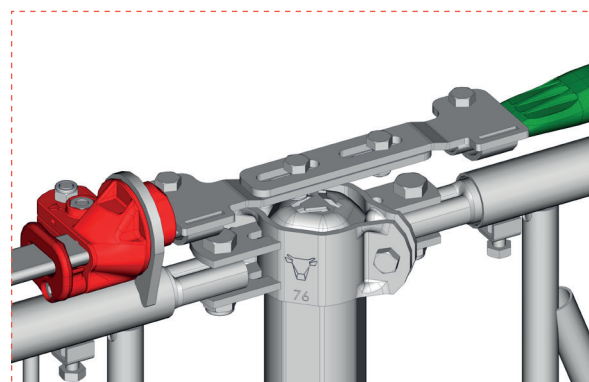
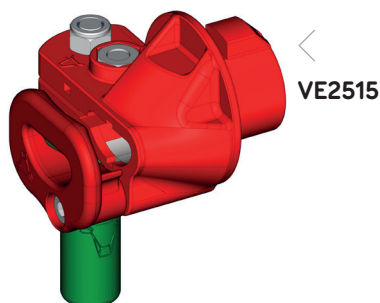

To fit linkage connections **ref. TR9901**, the posts must be sealed lower, ensuring the posts are not higher than the fastening brackets. Also, the pins must be replaced by bolts Ø 14 mm.

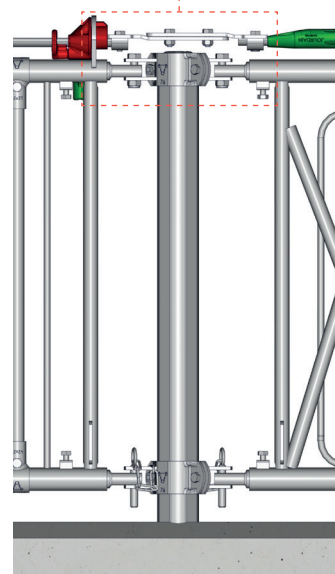
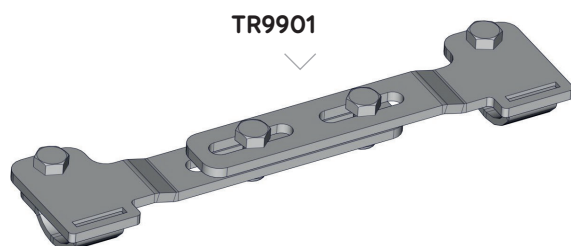

HEADLOCK END

The Headlock is supplied with 4 calf stands **ref. VE2790**, allowing the Headlock length to be adjusted during assembly.

CAUTION

Adjustable ends must not be stretched by more than 16.5 cm to the left, on the lever side and 11.5 cm to the lever side, on the right.

VE2790

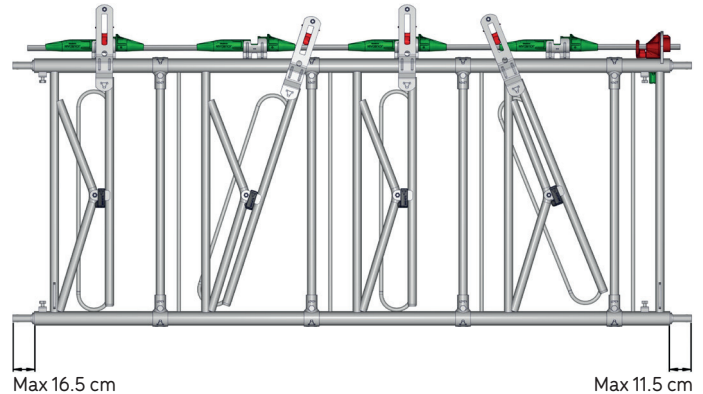
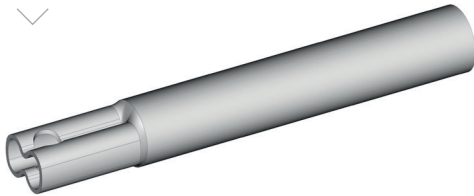

1 Headlock fastening yoke models

Different types of yokes and brackets are available according to the assembly. It is recommended to use cap **ref. FE2095** to prevent animals from playing with the pins.

FE2002

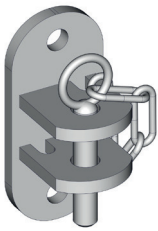

TR2596

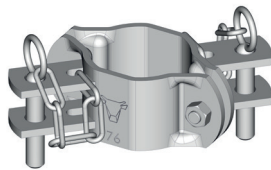

FE2095

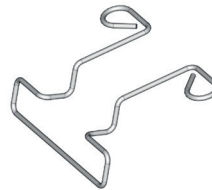

CAUTION

Do not omit to check holding of the chains over time.

2 Installing a gate

The gate allows entering the cubicle. Different options are possible.

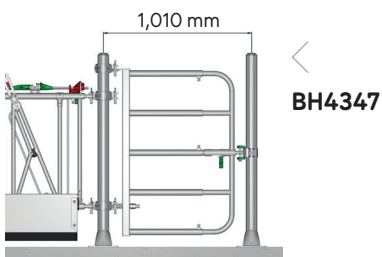

BH4347

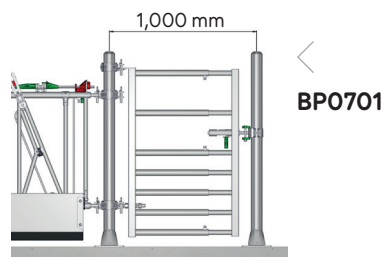

BP0701

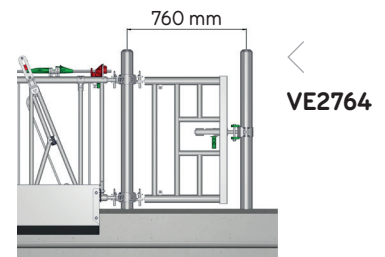

VE2764

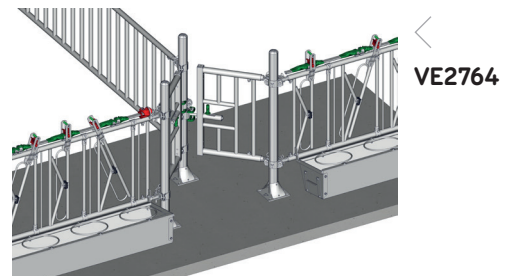
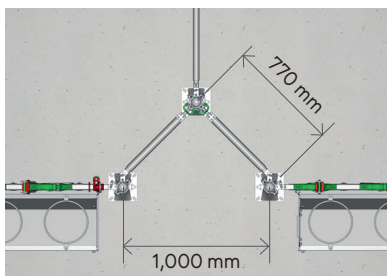

VE2764

USE

1 Self-service

The linkage has a self-service position for the animal to enter and leave freely.

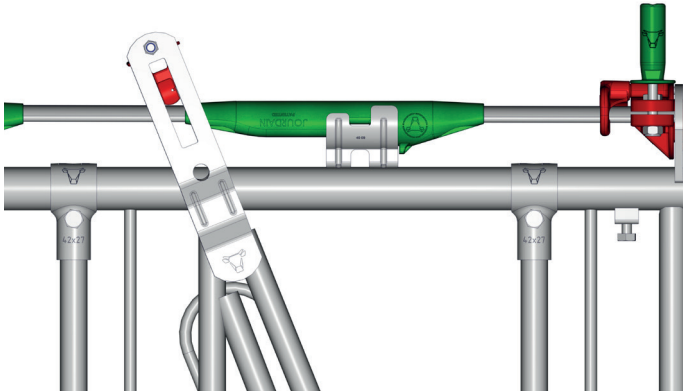

2 Locking position

By unlocking with one hand and turning the linkage by half a turn, it goes to the locking position in order to lock all animals regularly at the Headlock. Once they are used to it, the Headlock becomes a contention tool making it easy to calmly trap animals.

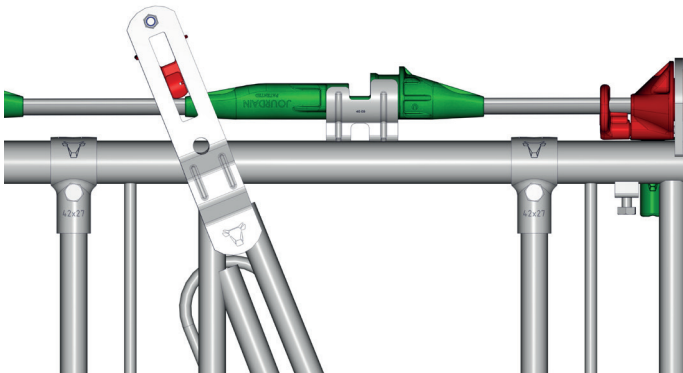

3 Maintaining an animal individually in the Headlock

Fit the individual locking axis **ref. SQ9939** then turn the linkage into the locking position. The ergonomic metallic part safely locks the animal before any intervention.

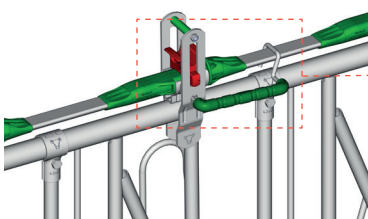

SQ9939

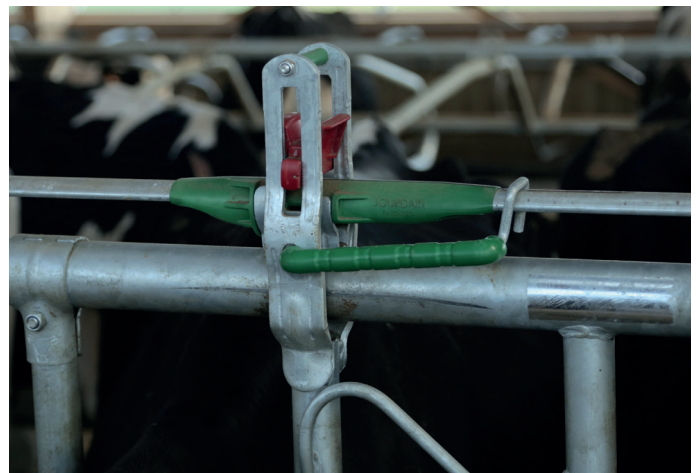
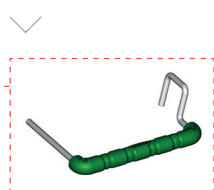

4 Unlocking

A restrained animal can be unlocked by lifting the red pin using the 2 wings, while remaining cautious with regard to any sudden movement of the animals or the mobile arm.

CAUTION

Do not place your hand on the Headlock when unlocking.
Please comply with currently applicable regulations for the animal's well-being.

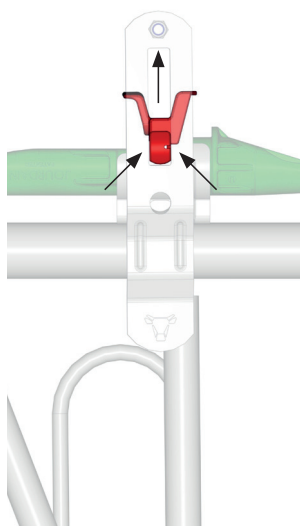

MAINTENANCE



Clean regularly between the control linkage and the stringer.

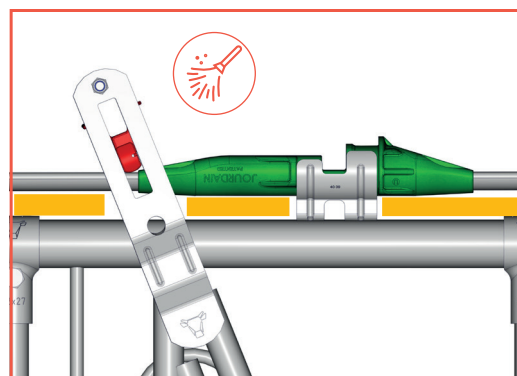

Regularly lubricate moving parts, joint axes of moving arms, control levers and any part necessary. Check screw tightness.

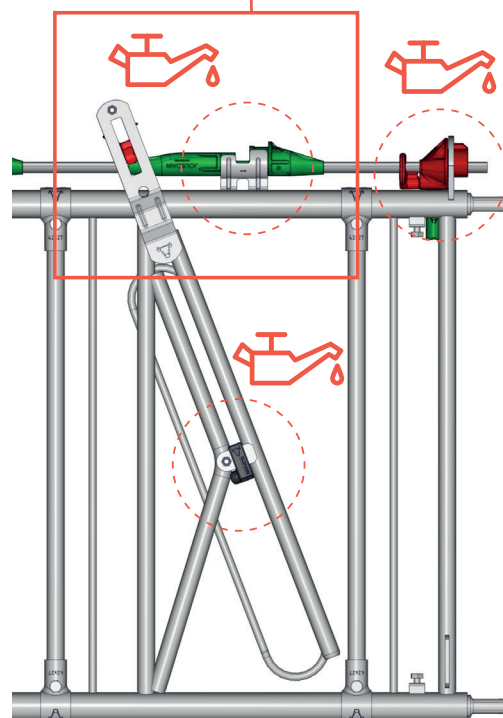

SAFETY

The installation and height of the headlock can be adapted according to the installation and livestock **E**. Adjustment of the neck restraint (dimension of the animal's neck) can be adjusted by the farmer according to the animals, their age and their morphology. For a calf, we recommend a setting of between 11 and 13 cm.

CAUTION

For safety, leave a maximum of 12 cm for a calf.



When the distance between the panel and the post exceeds 12 cm, we recommend fitting an anti-passage pin **ref. BA9931**.

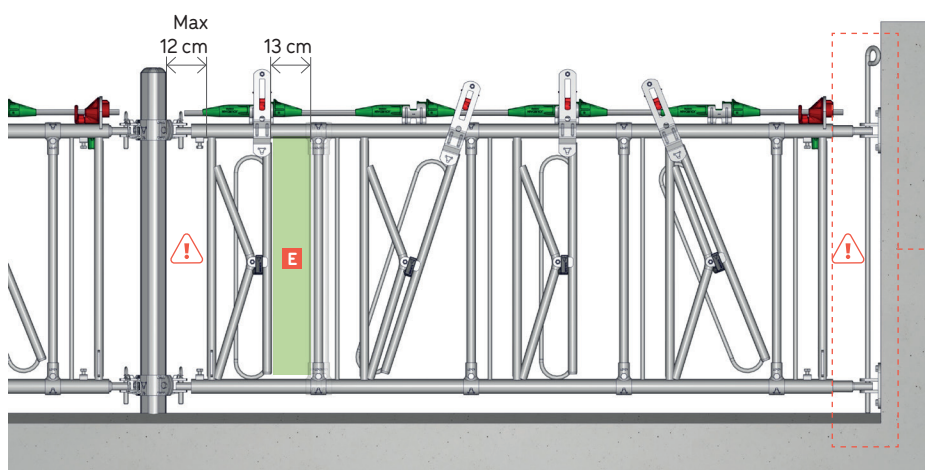

Also check the fasteners of the Headlock, the chains must remain in position. If removed by the animals, refit them and install in option the muzzle **ref. FE2095** to prevent opening by the animals.

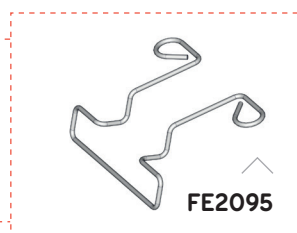
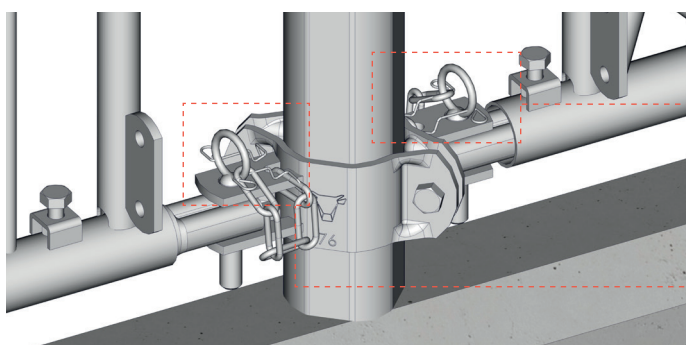



The step next to the animals, when building up, should be cured to ensure the animals are at the same Headlock height at all times, to ensure proper locking and operation.

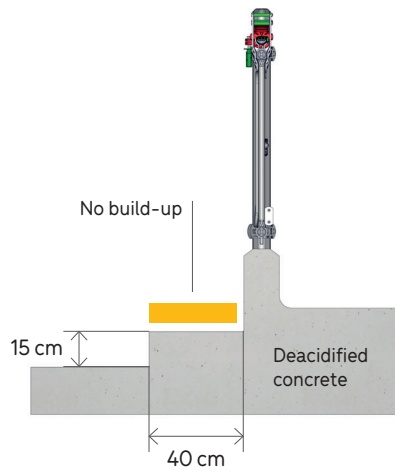

When the farmer is absent from the building, particularly at night, leave the Headlock in free-service.



CAUTION

Animals with collars are a potential source of accidents. Check the tightening of the collar depending on the animal's morphology. Use a collar with a safety device.

Despite the great care we take in the design of our products, always striving for optimal animal well-being and maximum safety levels. JOURDAIN cannot be held liable in the event of any accidents involving animals.

Knowledge and daily monitoring of the cattle by the farmer remain the most important solutions to prevent accidents.

CORROSION

Ground the equipment for safety and to limit corrosion. It is possible to fit a heat-shrinking sheath **ref. TR0101** or a themolacquered post to limit corrosion.

Silage accumulating on the Headlock low wall causes corrosion on the lower stringer.

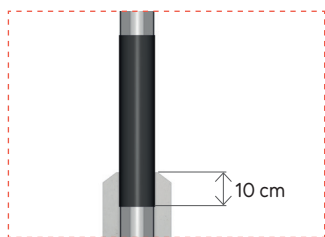
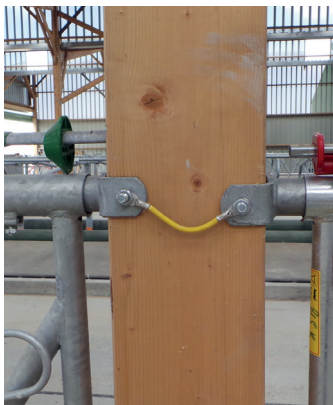
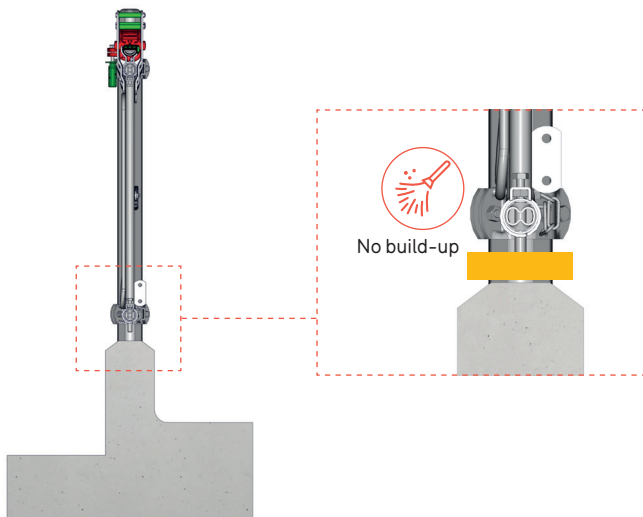

Adapt the height of the sock to the contact area, 10 cm under the concrete, and leave the metal post cemented in direct contact with the concrete.

Possibility of doubling the cementing sleeve **ref. TR4176** to form a dual sleeve and hence limit corrosion at the base of the post.



CAUTION



Corrosion in farming buildings is frequent because of aggressive agents and the environment.

Brush and paint with asphalt paint once the first traces appear.



TECHNICAL LITERATURE

NOTE: The dimensions are given in millimeters (mm).

A	Stringer length
B	Starting place dimension
C	Calf place dimension
D	Fastening centre distance
E	Post centre distance
F	Position of the cementable reinforcement
G	Max neck restraint

Calf Headlock
(fitting on octagonal post
Ø 76 mm & bracket)

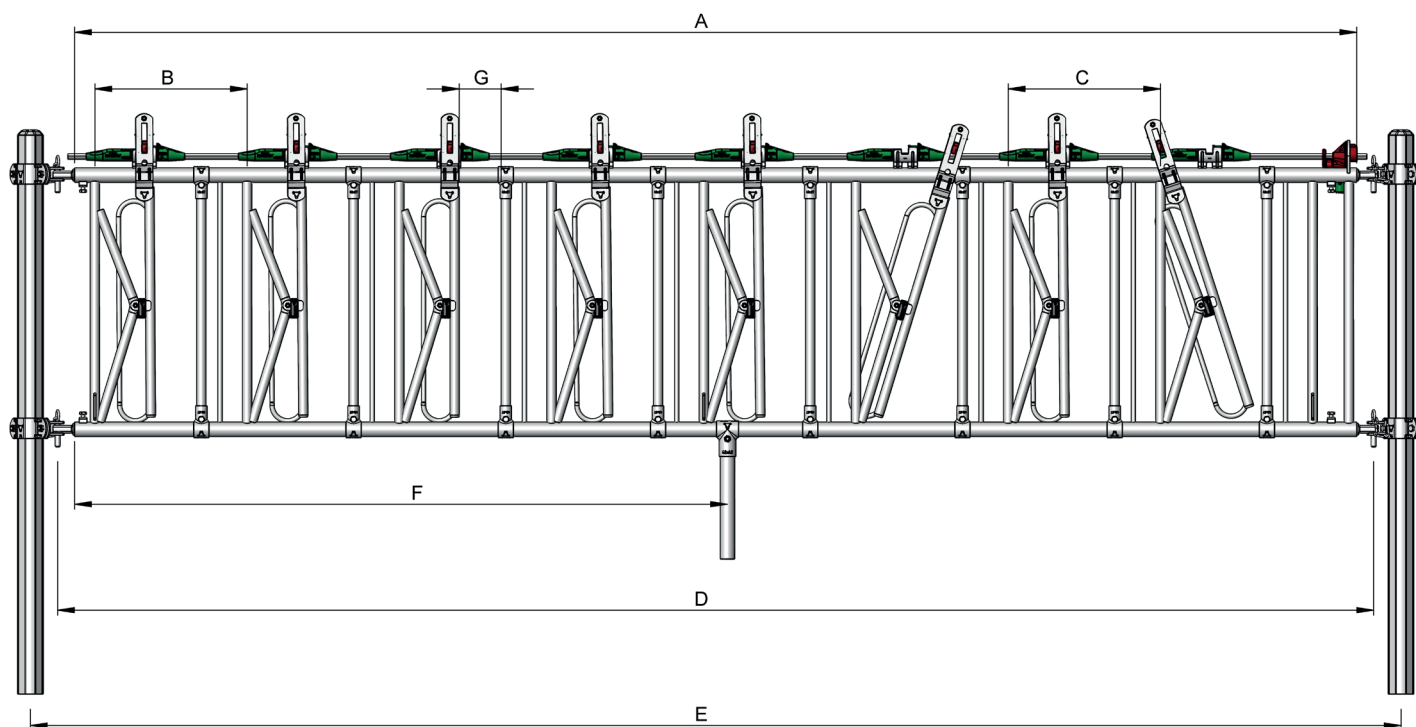

Ref. Price	Designation Headlock SAFETY® Calf	A	B	C	D (min)	E (min)	D (max)	E (max)	F	G
VE0401	Calf Headlock 4 places	1,890	450	450	1,980	2,142	2,146	2,308	-	150
VE0402	Calf Headlock 5 places	2,340	450	450	2,430	2,592	2,596	2,758	-	150
VE0403	Calf Headlock 6 places	2,790	450	450	2,880	3,042	3,046	3,208	-	150
VE0404	Calf Headlock 8 places	3,790	450	450	3,880	4,042	4,046	4,208	1,930	150
VE0405	Calf Headlock 10 places	4,790	450	450	4,880	5,042	5,046	5,208	2,480	150



The "Made in France" logo is a label that manufacturers or distributors may attach to their products under certain conditions in order to attest to their French origin:

- if a significant part of its value is derived from one or several production phases located in France,
- or if it has undergone its final substantial processing in France (source: www.economie.gouv.fr).

For JOURDAIN, this definition of "Made in France" is not enough, which is why we have created our own logo, certifying a much stronger commitment:

- the French manufacture of our products guarantees total control of design, manufacture, quality control and logistics in house, on our Escrennes site (in the central French department of Loiret).

2 AGENCIEZEBRA.COM - 05/2024



**Find all
our products**



WWW.JOURDAIN-GROUP.COM

always
INNOVATING

SAFETY® CALF HEADLOCK (ref. VE) | GCU

12/12